

96 lb/hr (1000 cc/min) Pro Import Injector

051000PI

96lb/hr (1000 cc/min) low impedance injector. Fits many Japanese/import applications.

Technical Specifications				
Flow Rate, lb/hr	96			
Flow Rate, cc/min	1000			
Impedance	Low (NOTE: May not work with factory ECU).			
Connector Style	Rectangular (minitimer)			
Dimensions*				
A (upper o-ring)	0.430	inch	11	mm
B (o-ring to o-ring length)	2.5	inch	63.5	mm
C (lower o-ring)	0.630	inch	16	mm
Recommended accessories	Component		P/N	
	Connector w/ wires:		0810	
	Connector only:		0811	

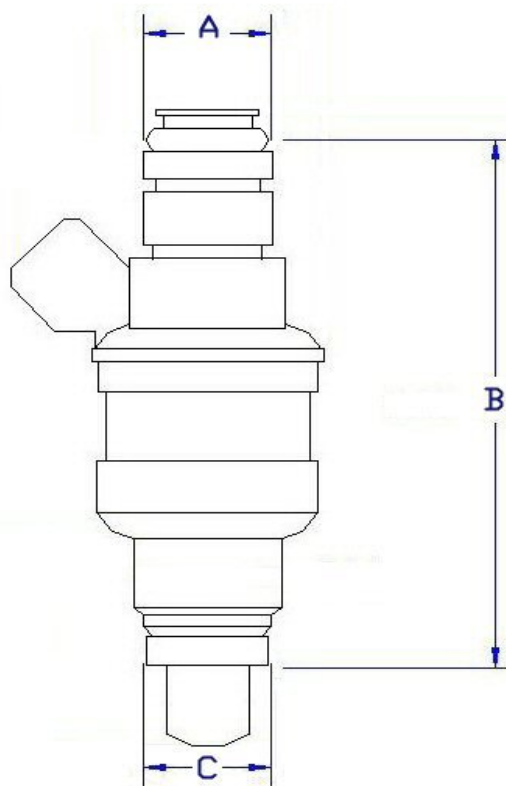

*Dimensions given are nominal and may vary slightly. For reference purposes only.

marren fuel injection

91 Willenbrock Road, Unit B2
Oxford, CT 06478
203-267-FUEL (3835)
www.injector.com